

STANDARD F hs-CRP



» Background

STANDARD F hs-CRP is an immunoassay for the quantitative measurement of C-reactive protein level in human serum, plasma, and whole blood. This test is performed to help predict a healthy person's risk of cardiovascular disease as part of a cardiovascular risk profile.

» Product Specification



STANDARD F hs-CRP	
Intended use	Quantitative measurement of hs-CRP level to predict a healthy person's CVD risk
Specimen type	Whole blood, Serum, Plasma
Specimen volume	5 µl
Measurement range	0.1 – 15 mg/L
Reference range	< 1.0 (Normal) 1.0 – 3.0 (Average risk) > 3.0 (High risk)
Testing time	3 mins
Storage condition	2 – 30°C / 36 – 86°F

» Test Procedure

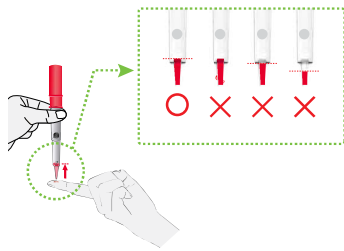

Collect 5 µl of sample. Finger tip blood can be used.

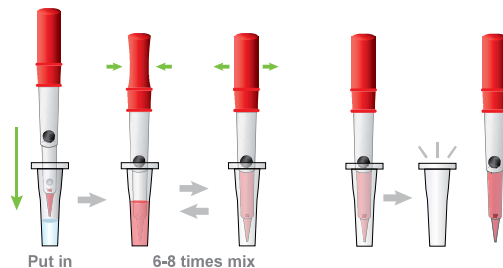

Mix collected sample with an extraction buffer until a latex tablet dissolves perfectly.

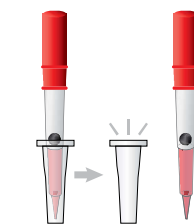

Collect all the mixture with a Spoit™ (Red).



Apply the sample mixture into the sample well of the test device.

» Method Comparison

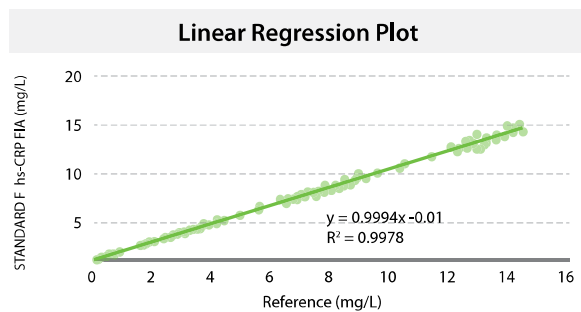

Reference method vs STANDARD F hs-CRP

Correlation vs Roche cobas $y=0.9994x-0.01; r=0.9989; n=120$

CV% QCL=7.6% / QCM=9.7% / QCH=9.8%

Differ(%) Within 15%

» Ordering Information

Category	Product	Pack Size	CAT No.
Cardiovascular disease	STANDARD F hs-CRP	20 Tests	10HSC10B
	STANDARD F hs-CRP Control	Lv1 x 10 / Lv2 x 10	10HSC10