

STANDARD F CRP



» Background

STANDARD F CRP is an immunoassay for the quantitative measurement of C-reactive protein level in human serum, plasma, and whole blood. CRP helps assess the severity and prognosis of inflammation and infection.

» Product Specification



STANDARD F CRP	
Intended use	Quantitative measurement of CRP level for the clinical management of infection
Specimen type	Whole blood, Serum, Plasma
Specimen volume	5 µl
Measurement range	1 – 150 mg/L (Whole blood) 1 – 130 mg/L (Serum, Plasma)
Reference range	≤ 10.0 mg/L
Testing time	3 mins
Storage condition	2 – 30°C / 36 – 86°F

» Test Procedure

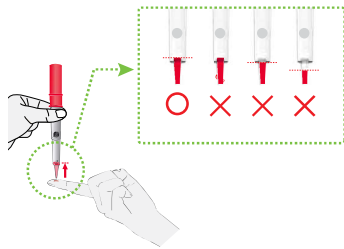

Collect 5 µl of sample. Finger tip blood can be used.

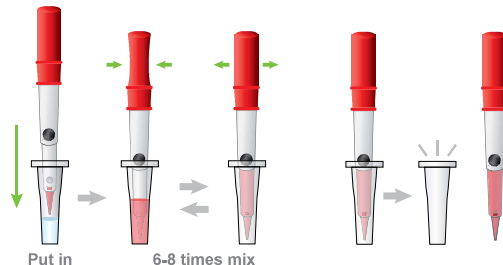

Mix collected sample with an extraction buffer until a latex tablet dissolves perfectly.

Collect all the mixture with a Spoit™(Red).



Apply the sample mixture into the sample well of the test device.

» Method Comparison

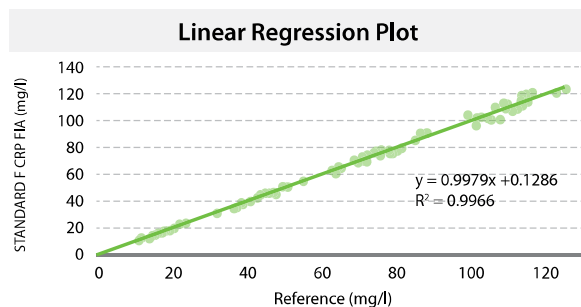

Reference method vs STANDARD F CRP

Correlation vs Roche cobas $y=0.9979x; r=0.9966, n=120$

CV% QCL=2.1% / QCM=3.0% / QCH=4.2%

Differ(%) within 15%

» Ordering Information

Category	Product	Pack Size	CAT No.
Inflammation	STANDARD F CRP	20 Tests	10CRP10B
	SDB CRP Control	Lv1 x 10 / Lv2 x 10	03CCS10