

NOVINKA

Screw Cap Tubes s nově navrženým uzávěrem dokonale zabrání úniku tekutiny

0.5 - 1.5 - 2.0 ML CONICAL and FREE STANDING in 10 DIFFERENT COLORS



WELCOME

- Smart closure
- Non leaking
- Organic solvents
- Full recovery
- No molecule binding
- Color coded tube
- Color coded cap
- Boiling water-baths
- Cold freezers
- Kit composers
- Proper SOP's
- Reproducibility guru's

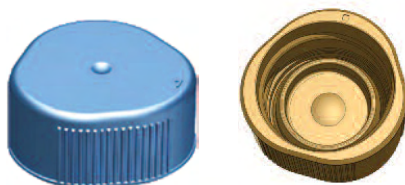

PRACOVNÍ ROZPĚTÍ
-200°C až +100°C

Nyní s novými víčky které
otevřete jednou rukou



FAREWELL

- O-rings
- Leakage
- Spillage
- Contamination
- Sample loss
- Degradated o-rings
- Mixing-up items
- Cracked - o - rings
- Inconsistency

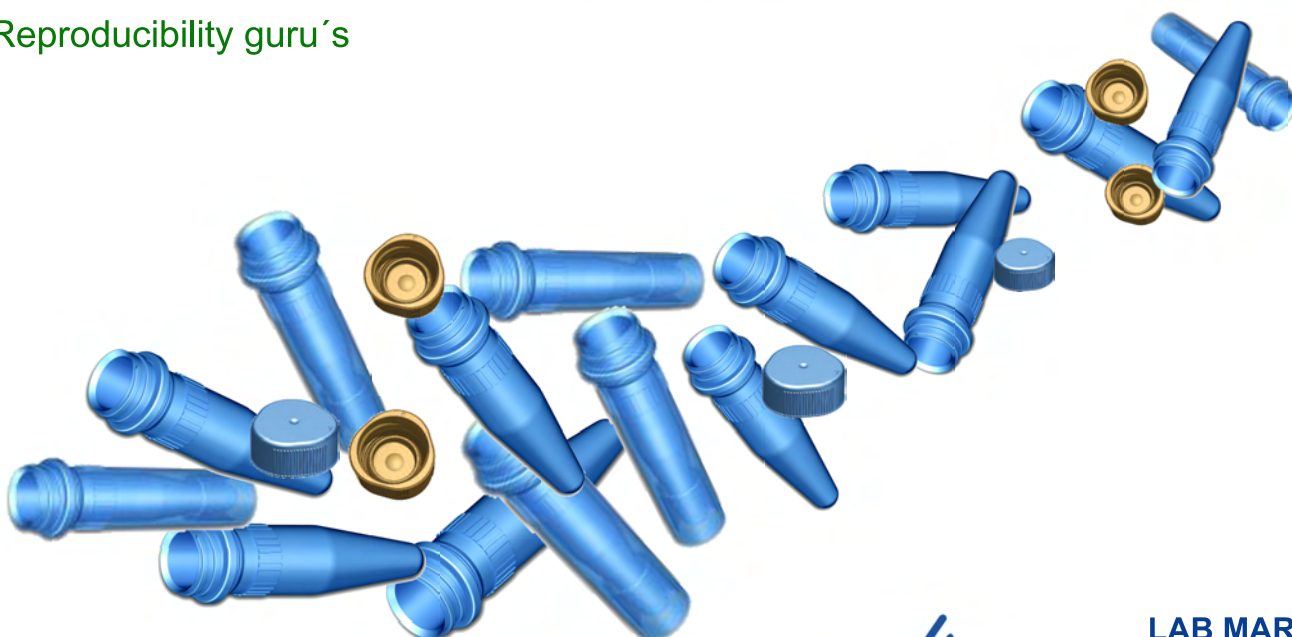

ZKUMAVKY S NOVOU TECHNOLOGÍ UZÁVĚRU

Představujeme novinku - Screw Caps Tubes with Smart Secure Technology. Ta nepoužívá "rubber ring", při jehož užití by mohlo dojít ke kontaminaci vzorku, jeho rozpuštění v organickém roztoku nebo poškození při manipulaci v nižších teplotách. Toto nově navržené víčko můžete opakovaně zavírat a otevírat i za extrémních podmínek bez jakéhokoli defektu a ztráty vzorku.

BAREVNÁ VÍČKA I ZKUMAVKY

Abychom se vyvarovali kontaminaci vzorku například chybným použitím nesprávného víčka zkumavky, jsou u řady zkumavek víčka jejich trvalou součástí. Ovšem pipetování zkumavky s víčkem není úplně optimální. Nechtěným pohybem víčka při pipetování může dojít ke kontaminaci nebo ztrátě vzorku a také k omezení prostoru kolem otvoru zkumavky. Z toho důvodu firma Bioplastics nabízí nejen barevná víčka ale i zkumavky, aby bylo možno předejít záměně víčka a přitom nemuselo být přichyceno při práci na zkumavku.

PŮVODNÍ TRADIČNÍ VÍČKO & ZKUMAVKA s "O-RINGS"

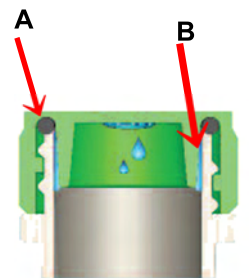
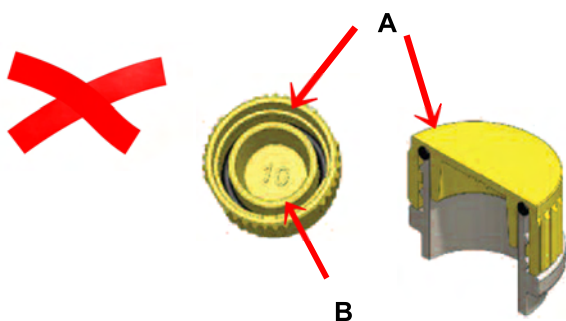

NOVÉ ZKUMAVKY & VÍČKA S CHYTRÝM SYSTÉMEM ZAVÍRÁNÍ

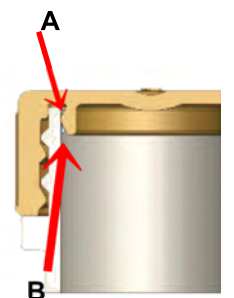
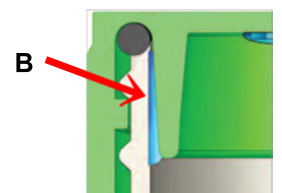
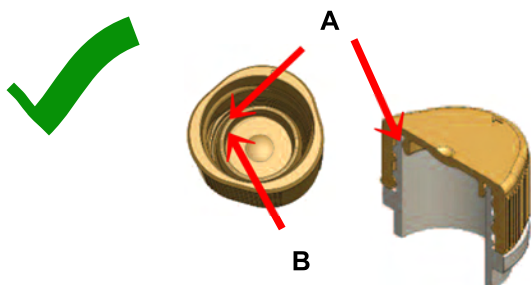

HOW TO OPEN AND CLOSE THE TUBES EASILY

This is how you do it.....

SCREW THE TUBE TO THE CAP instead of the cap to the tube

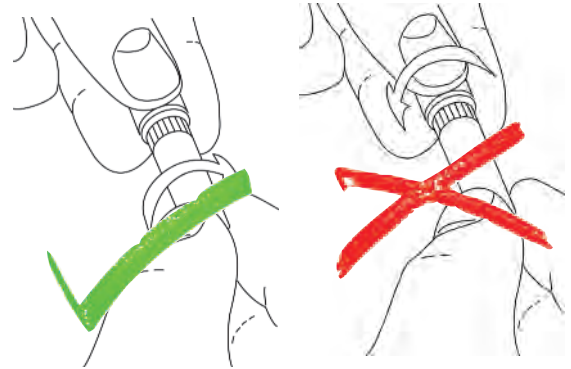

FROSTED TUBES, CLEAR TRANSPARENT TUBES

The tubes are all slightly frosted to assure good grip even in wet conditions. If you apply a transparent label or regular cello tape your frosted tube becomes very clear and transparent at the label/tape position

0.5 ml Screw Cap Tubes

Conical (without screw caps)



Orderno Description

Package Size

B71057 Natural, 0.5 ml conical screw cap tube bag, 500

B91002	red	B91005	yellow	B91008	amber	B91011	natural, sterile
B91003	blue	B91006	orange	B91009	white	B91012	SW colors
B91004	green	B91007	violet	B91010	black		



Free Standing (without screw caps)



Orderno Description

Package Size

B71060 Natural, 0.5 ml free standing screw cap tube bag, 500

B91032	red	B91035	yellow	B91038	amber	B91041	natural, sterile
B91033	blue	B91036	orange	B91039	white	B91042	SW colors
B91034	green	B91037	violet	B91040	black		



1.5 ml Screw Cap Tubes

Conical (without screw caps)



Orderno Description

Package Size

B71058 Natural, 1.5 ml conical screw cap tube bag, 500

B91102	red	B91105	yellow	B91108	amber	B91111	natural, sterile
B91103	blue	B91106	orange	B91109	white	B91112	SW colors
B91104	green	B91107	violet	B91110	black		



Free Standing (without screw caps)



Orderno Description

Package Size

B71061 Natural, 1.5 ml free standing screw cap tube bag, 500

B91132	red	B91135	yellow	B91138	amber	B91141	natural, sterile
B91133	blue	B91136	orange	B91139	white	B91142	SW colors
B91134	green	B91137	violet	B91140	black		



2.0 ml Screw Cap Tubes



Conical (without screw caps)

Orderno Description Package Size
 B91201 Natural, 2.0 ml conical screw cap tubebag, 500

B91202	red	B91205	yellow	B91208	amber	B91211	natural, sterile
B91203	blue	B91206	orange	B91209	white	B91212	SW colors
B91204	green	B91207	violet	B91210	black		



Free Standing (without screw caps)



Orderno Description Package Size
 B71072 Natural, 2.0 ml free standing screw cap tubebag, 500

B91232	red	B91235	yellow	B91238	amber	B91241	natural, sterile
B91233	blue	B91236	orange	B91239	white	B91242	SW colors
B91234	green	B91237	violet	B91240	black		



Screw caps

Screw caps with S-mart Secure Closure Technology (all applications)

By using screw caps with Secure Closure Technology excellent closure of the tubes is guaranteed. Screw caps are available in nine different colors. For use with all 0.5 ml, 1.5 ml and 2.0 ml screw cap tubes..For robust applications such as long term storage: ≥ 3 years below - 60 °C or incubation at ≥ 95 °C for ≥ 2 hours

Orderno Description Package Size
 B91300 Natural, screw capbag, 500

B91302	red	B91305	yellow	B91308	amber	B91311	natural, sterile
B91303	blue	B91306	orange	B91309	white		
B91304	green	B91307	violet	B91310	black		



Screw caps with S-mart Secure Closure Technology (Medium & mild applications) Type Easy Opening & Closure (one hand)

Screw caps are available in nine different colors. For use with all 0.5 ml, 1.5 ml and 2.0 ml screw cap tubes.For less robust applications: ≤ 3 years higher than -60 °C or less stringent incubation ≤ 100 °C ≤ 1.5 hours.

Orderno Description Package Size
 B91400 Natural, screw cap, Easy Opening and Closurebag, 500

B91402	red	B91405	yellow	B91408	amber	B91411	natural, sterile
B91403	blue	B91406	orange	B91409	white		
B91404	green	B91407	violet	B91410	black		

NEW



Working range:

Tubes & Caps: -200°C - +100°C and centrifuged up to 20.000 g, with the correct rotor support up to 40.000 g.

All products are DNA(se) RNA(se), Pyrogen, Metal and ATP free

© BIOplastics 07-2009

Your Local Distributor:



Head Quarters:

BIOplastics BV
 Rötischerweg 61
 Entrance D
 6374 XW Landgraaf
 The Netherlands
 Telephone: +31 (0)45 533 87 50
 Fax: +31 (0)45 533 87 96
 Website: www.bioplastics.com
 E-mail: info@bioplastics.com

Subsidiary:

BPCTi Inc.
 2933 South Miami Blvd.
 Suite 121
 Durham, NC 27703, USA
 Telephone: 919 806 8811
 Fax: 919 806 2014
 E-mail: info@bpcti.com
 Website: www.bpcti.com

